

**1954 PA 188 Proceedings
 Notice of Improvement Hearing
 Township of Hamburg
 Livingston County, Michigan**

TO: THE RESIDENTS AND PROPERTY OWNERS OF THE TOWNSHIP OF HAMBURG, LIVINGSTON COUNTY, MICHIGAN AND ANY OTHER INTERESTED PERSONS.

PLEASE TAKE NOTICE that as a result of Petitions from property owners within the township signed by the record owners of land whose footage constitutes more than 50% of the total (approx. 1,690 linear feet) of the hereinafter described **Norene and Peary Drive - Road Maintenance Special Assessment District**, the Township Board of the Township of Hamburg proposes to re-establish the district to provide: up to three (3) gradings per year as necessary; up to 60 cubic yards of road quality (22A) gravel annually as necessary; snow removal - up to eight (8) times per year, as necessary, for the removal of four (4) inches or more of accumulation; and sanding up to eight (8) times per year when icy conditions require.

PLEASE TAKE FURTHER NOTICE that the District within which the foregoing road maintenance services are proposed and within which the cost thereof is proposed to be assessed consists of the lands identified in the map attached to this notice and are more specifically identified by the following permanent parcel numbers:

15-36-100-007	15-36-100-008	15-36-100-015	15-36-100-016
15-36-100-020	15-36-100-021	15-36-100-078	15-36-100-083
15-36-100-088	15-36-100-089	15-36-100-090	15-36-100-092
15-36-200-015	15-36-200-016	15-36-200-017	15-36-200-018
15-36-200-019	15-36-200-020	15-36-200-037	15-36-200-038
15-36-200-039	15-36-200-056	15-36-200-057	

PLEASE TAKE FURTHER NOTICE that the Township Board has passed a Resolution tentatively declaring its intention to re-establish the aforementioned Special Assessment District and has further tentatively found the Petitions for the road maintenance to be in compliance with statutory requirements.

PLEASE TAKE FURTHER NOTICE that said Special Assessment District and Petitions may be examined at the office of the Township Clerk from the date of this Notice until and including the date of the public hearing hereon and may further be examined at such public hearing.

PLEASE TAKE FURTHER NOTICE that a public hearing upon such Petitions, and road maintenance cost estimates will be held at the Hamburg Township Hall located at 10405 Merrill Road, Hamburg, Michigan, commencing at 6:30 p.m. on **Tuesday, March 21, 2017**.

At such hearing, the Board will consider any written objections to any of the foregoing matters which might be filed with said board, at or prior to the time of said hearing as well as any revisions, corrections, amendments, or changes to said Petitions, Estimates and Costs or to said Special Assessment District.

All interested persons are invited to be present at the aforesaid time and place and to submit comments concerning any of the foregoing.

MICHAEL DOLAN
 HAMBURG TOWNSHIP CLERK
 10405 MERRILL ROAD, BOX 157
 HAMBURG, MICHIGAN 48139
 (810)231-1000 EXT. 206
 EMAIL: MDOLAN@HAMBURG.MI.US

Norene/Peary Drive - Road Maintenance District
 Hamburg Township, Livingston County, Michigan

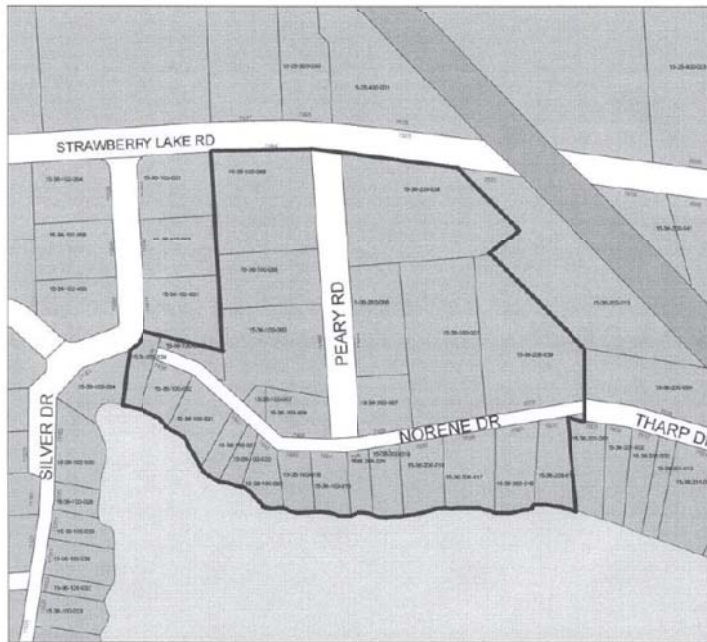

NOTE: Bold black outline indicates road maintenance district boundaries.

(03-08/15-2017 DAILY 314761)